

Installation Manual for Splash Proof Water Heater Connector 25A

MODEL: WHC-1 LFI-4W

RATING : 25 AMPERE

INSTALLATION PROCEDURES

1. Turn off the double pole switch that is connected to the socket.
2. Remove the socket from the wall, and detach connecting wirings from the socket.



Figure 1 - Example of a socket placed in bathrooms, to be replaced with a Splash Proof Connector.

3. Connect Live (brown/red) wire to L point of terminal block (Fig. 2)
Connect Neutral (blue/black) wire to N point of terminal block (Fig. 2)
Connect Earth (green/yellow) wire to ⊕ point of terminal block (Fig. 2)

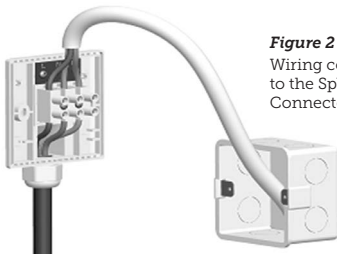

Figure 2 - Wiring connections to the Splash Proof Connector.

4. Apply minimum torque of 1.2Nm / 120cNm while tightening the screws to ensure all wires are securely connected to the terminal block.

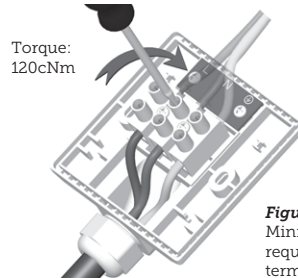

Figure 3 - Minimum torque required to fasten terminal connections.

5. Connect wire from Splash Proof Water Heater Connector to water heater's built-in terminal block. Recommended strip length is 8mm. (Fig. 4)

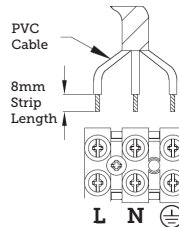

Figure 4 - Recommended Strip Length for wiring connection to water heater's built-in terminal block.

6. Secure the Splash Proof Connector to the junction box using the screws provided. The screws and the screw caps can be found at the back of the connector. (Fig. 5)

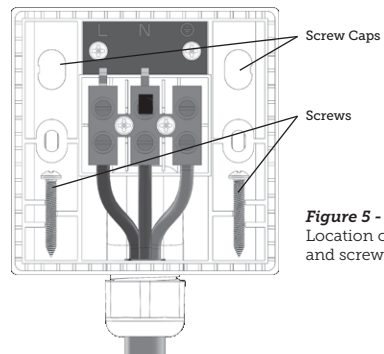

Figure 5 - Location of screws and screw caps

7. Maintain a 'U' curved wiring connection between the Splash Proof Connector and the water heater, to prevent water droplets from flowing into the water heater via the cable entry point. (Fig. 6)

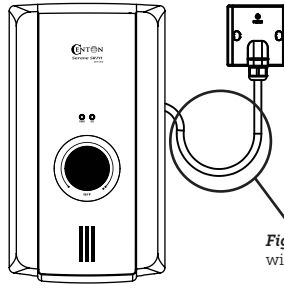

Figure 6 - 'U' curved wiring connection.

LINE FAULT INDICATOR (LFI) FUNCTION

The built in Line Fault Indicator will indicate 'GREEN' light if wiring is done correctly or 'RED' light if improper electrical wiring is detected.

If the Line Fault Indicator indicates 'RED' light, switch off the main power supply and contact a qualified electrician to check on your electrical connection. Please refer below for the possible improper wiring connections.



WARNING

Improper earthing may result in malfunction to the RCCB / RCD. Never use the product if there is doubt on the Earthing installation.

RED light warning shows if there is an improper electrical connection.

Possible Causes

- Earth wire not connected to WHC-1 LFI.
- Live & Neutral phase are reversed.
- Earth conductor not grounded (floating) or have high resistance to ground.