



## Splash-Proof Water Heater Connector



Max Rating



Cable Included



Cable Diameter



Fire-Retardant



Approved



Suitable for Air Conditioner



Suitable for Electric Cooker Hob

# Splash-Proof Water Heater Connector

Centon

The use of plugs and sockets, and even substandard junction boxes to power up water heaters in bathrooms pose life-threatening risks to users, with dangers including electrocution hazards, fire / explosion hazards, and short circuit hazards.

Eliminate these risks with Centon's Water Heater Connector - approved by Suruhanjaya Tenaga and in compliance with the national wiring standards, this splash-proof and fire retardant junction box securely powers up your water heater to provide you with safe and sensational showers with a peace of mind!

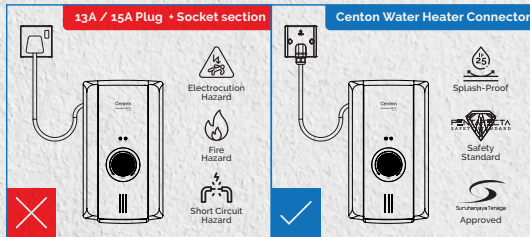
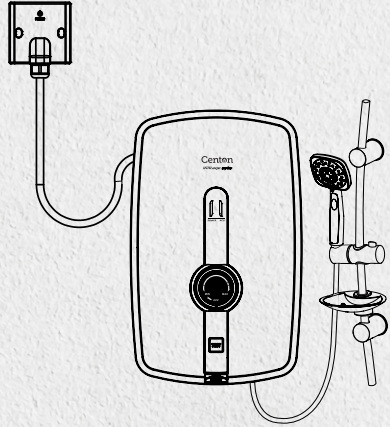

## SUITABLE FOR:

- Instant Water Heater
- Storage Water Heater

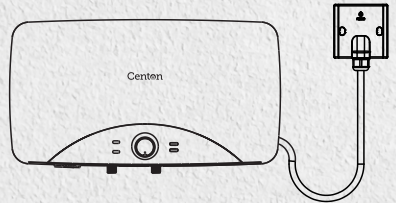

**The Line Fault Indicator (LFI)** boosts the importance of this connector and detects any improper electrical connection, especially the absence of earth connection, saving you from the risk of electrocution.



## TECHNICAL SPECIFICATIONS

Model	WHC-1 LFI-4W
Rated Voltage	250 V A.C.~
Rated Ampere	25 A
Rated Power	5.5 kW
Water Ingress Protection	IP25
Tested and comply to	IEC 60998-1 & IEC 60670-22 Ed.11 b: 2015.
Material	Fire-retardant Thermoplastic: Polycarbonate (PC)
Wire Length	1.0 Metre
Wire Type	4.0mm <sup>2</sup> diameter, 3 core cable

**CENTON HOME APPLIANCES SDN. BHD.**  
11289180-PI

21, Jalan Seruling 58, Taman Klang Jaya,  
41200 Klang, Selangor, Malaysia

+603 3324 7605 / 7606

+603 3324 7608

support@centon.my

www.centon.my



Industrial Design Registration No.: MY16005280101