

Centon

Cyclone

STAND FAN

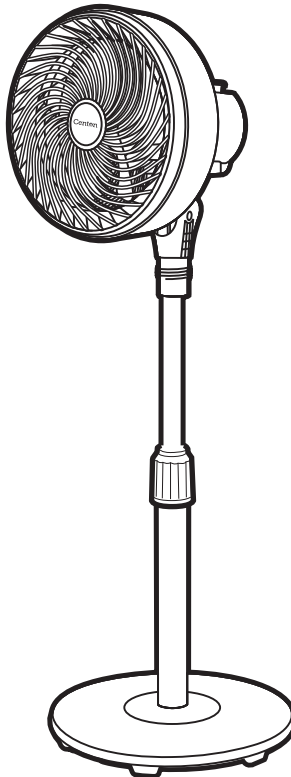

INSTRUCTION MANUAL

Please read this manual carefully before operating this product.
Keep this manual handy for further reference.

CAUTION

1. This appliance is not intended for use by persons (including children) with reduced physical, sensory or mental capabilities, or lack of experience and knowledge, unless they have been given supervision of instruction, concerning use of the appliance by a person responsible for their safety. Children should be supervised to ensure that they do not play with the appliance.
2. If the supply cord is damaged, it must be replaced by the manufacturer, its service agent or similarly qualified persons in order to avoid a hazard.
3. Ensure that the fan is switched off from the supply mains before removing the guards for cleaning & maintenance purpose.
4. Switch off and unplug outlet when the product is not in use.
5. This product is intended for normal domestic / household use only.
6. Always operate the product from a power source of the same voltage, frequency & rating as indicated on the product identification plate.
7. Do not use this fan with any solid state speed control device to reduce the risk of electric shock.
8. Do not leave the fan running unattended.
9. Do not operate the product if it is dropped, damaged or showing signs of product malfunction. Do not operate the product with a damaged plug or cord.
10. Do not immerse or expose the product or flexible cord to rain, moisture or any other liquid.
11. This product should not be used in the immediate vicinity of water ,such as bathtubs, washbowls, swimming pools etc.
12. Avoid contact with moving parts. Do not insert any body parts (e.g. finger) or object through the fan guards when the fan is operating.
13. Do not cover the fan guards, or operate in close proximity to curtains,etc.

PARTS IDENTIFICATION

- | | |
|-------------------|---------------------|
| 1. Front Guard | 7. Oscillation Knob |
| 2. Spinner | 8. Motor |
| 3. Fan Blade | 9. Pole |
| 4. Rear Guard Nut | 10. Base Cover |
| 5. Rear Guard | 11. Heavy Base |
| 6. Switch Knob | 12. Base Lock |

SPECIFICATIONS	
Model:	Cyclone
Blade Size	8 inches
Voltage:	220-240V ~ 50/60Hz
Power:	90W
Max. RPM:	2100
No. of Speed:	3

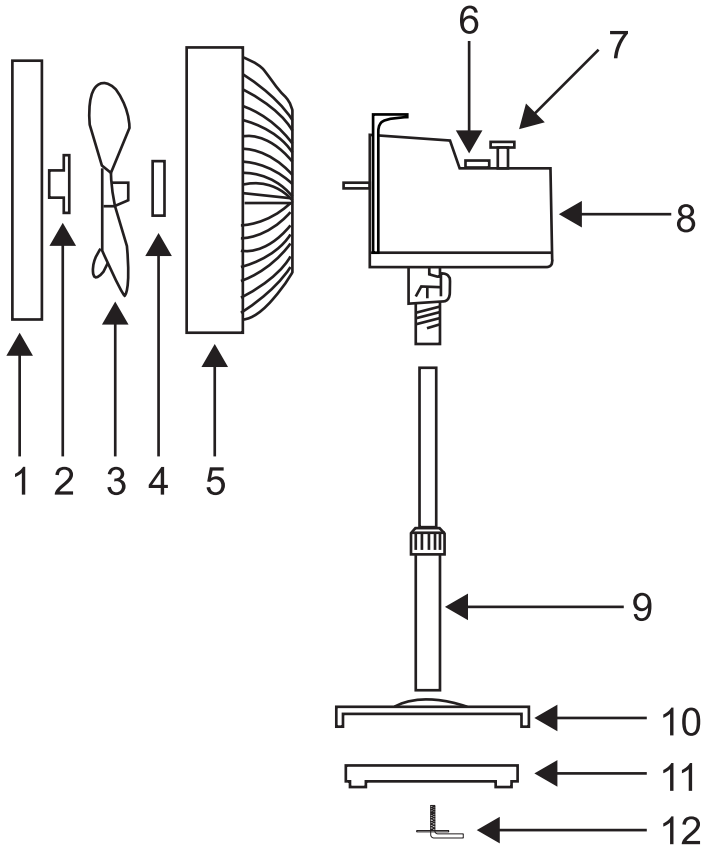

INSTALLATION

Assemble of Fan Base

1. Loosen the "L" screw from bottom of the pole.
2. Place the pole on round base & fix with "L" screw.
3. Push the fan body into the pole fully and secured it with screw .

Assemble of Fan Body

1. To assemble the fan guard & blade, remove the spinner (by turning it clockwise), then the guard lock nut (by turning it anticlockwise) from the motor shaft.
2. Remove safety screw from rear guard. Turn the Front Guard anti-clockwise to disassembly fan blade and guard.

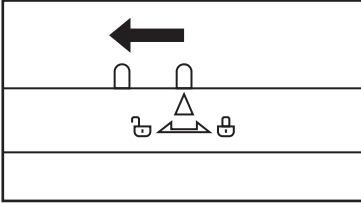

3. Place rear guard into the position, ensure its fits into the locating lugs. The guard handle should be at the top.
4. Fasten the rear guard tightly by turning the guard lock nut clockwise.
5. Insert the blade to the shaft and ensure the pin must enter the blade slot.
6. Tighten the blade using spinner. Turn anti-clockwise. The spinner is self-tightening, do not force it.
7. Locate the arrow at unlock position & turn clockwise to lock the front guard.

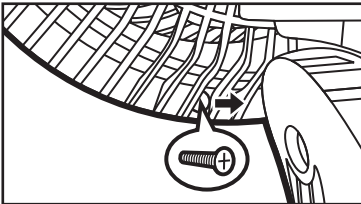

8. Screw back the safety screw at the rear guard for safety purpose.

HOW TO USE

1. Place appliances on a stable surface when operating.
2. Select the required speed by turn the speed selector at the top of motor assembly.
3. Press or lift the oscillation knob to start or stop fan oscillation.
4. To adjust vertical angle, switch off the appliances and tilt angle up or down as needed.

CLEANING & MAINTENANCE

1. Before cleaning and maintaining, disconnect the power supply for safety purposes.
2. Always keep the air vents at rear motor cover clean.
3. Handle blade with care during cleaning.
4. Fan parts such as fan blade, rear guard, front guard should be cleaned using mild soap/ damp cloth or sponge. Do not allow any water or other liquid to enter the motor.

Note : Do not use harsh detergents, chemical cleaners or solvents as they may damage the surface of the appliances.

CENTON HOME APPLIANCES SDN. BHD. [1289180-P]

21, Jalan Seruling 58, Taman Klang Jaya,
41200 Klang, Selangor, Malaysia



www.centon.my



support@centonia.my